



rapPORT

A [W]RAP UP OF OUR ACTIVITIES FOR OUR COMMUNITY



New Board of Directors for Townsville Port Authority

The Board of Townsville Port Authority has been reconstituted by the Queensland Government with effect from 1 July 2005.

CHAIRMAN Ron McLean has been re-appointed until the end of September 2007 and three of the other five Directors whose terms expired have been replaced.

Chairman Ron McLean said, "From my perspective I am very pleased to have been re-appointed, but pay tribute to the very strong contribution made by Dale Parker, Jenny Gleeson and Terry Baxter.



"I also welcome three new Directors who will enhance the range of skills and knowledge on the Board. They are Ken McElligott, a former Director of the Authority and more recently a Queensland Minister, Paul Keehan, Corporate Manager for a Brisbane based Investment Bank with experience in finance, marketing and strategic development and Melissa Griffith, a Civil Engineer with experience in maritime and coastal engineering, based in Brisbane with Kellogg, Brown and Root.

"I look forward to their positive and fresh contribution to further develop the Port and industries in the region it serves."



Paul Keehan
InterFinancial, Brisbane



Ken McElligott
Former Director, Townsville



Melissa Griffith
Kellogg, Brown & Root, Brisbane

The new Board of Townsville Port Authority

- Mr Ron McLean,	Chairman	appointed until 30/09/2007
- Ms Beth Keating,	Deputy Chair	appointed until 30/06/2006
- Cr Tony Mooney,	Director	appointed until 30/09/2007
- Prof Stephen Graw,	Director	appointed until 30/09/2008
- Mr John Pennisi,	Director	appointed until 30/06/2006
- Hon Mr Ken McElligott,	Director	appointed until 30/09/2007
- Mr Paul Keehan,	Director	appointed until 30/09/2007
- Mrs Melissa Griffith,	Director	appointed until 30/09/2007



Dredging up the past...

Breakwater Casino Development circa 1994

At the helm - from the CEO



WE begin the new financial year with an ambitious maintenance program to bring Port infrastructure up to the best possible condition to ensure reliability for our customers.

In the past few months we have been literally inundated with enquiries from potential new trades and these are being pursued vigorously. If successful, these new trade enquiries will place further demands on the Port and we are therefore producing a sound strategic transport plan which will enable us to meet these changing demands. Some major maintenance programs to be undertaken in the year ahead include an upgrade to the Berth 1 above deck infrastructure.

FEEDBACK SURVEYS

Thanks to those of you who took the time to participate in our feedback surveys recently. We have reviewed the results carefully and are now putting in place action plans to address some key areas. See page three for more details of these.

SECURITY UPGRADES

The upgraded security arrangements at the Port have proved very successful. A recent audit by the Department of Transport and Regional Services (DOTARS) and an independent auditor determined the security measures to be

working well. The year ahead will also see the introduction of new security cards. See this page for more details.

VP60

As part of the city's VP60 celebrations, Townsville Port Authority is the proud sponsor of the Skyshow on 13 August 2005. This promises to be a very special event and we hope you will give it your full support. We are pleased to be a part of the celebrations, given Townsville's rich history of wartime Port activities. This has continued to be the case to present day, with our close relationship with the US Navy and our involvement in the recent exercise Talisman Sabre, which saw the Port hosting US Naval vessels such as the *USS Boxer* and *USS Blue Ridge*. A big thank you to our customers for their patience and assistance during the exercise in facilitating these visits.

ENVIRONMENT

The Port Authority continues to focus on the environment with our participation in National Tree Day on 31 July. You will also find information on page four on air quality improvement initiatives currently being undertaken.

Finally, trade statistics for the 2004/05 financial year are being finalised and further information will be released soon.

Maritime Security Identification Card (MSIC) - Your Questions Answered

WHAT IS A MARITIME SECURITY IDENTIFICATION CARD (MSIC)?

The MSIC is a nationally consistent identification card which states that the holder has met the background checking requirements to work in a Maritime Security Zone.

WHAT IS ITS PURPOSE?

An MSIC is designed to give assurance that people who hold an MSIC do not pose a threat to maritime security. MSICs are only issued after the completion of three background checks: a criminal background check by the Australian Federal Police (AFP), a security assessment conducted by the Australian Security Intelligence Organisation (ASIO) and, if required, an unlawful non-citizen check by the Department of Immigration, Multicultural and Indigenous Affairs (DIMIA).

WHAT ARE MARITIME SECURITY ZONES?

Maritime Security Zones include Port Security Zones, Ship Security Zones and Onboard Security Zones. The MSIC will also cover personnel on Offshore Oil and Gas Facilities subject to the Maritime Transport Security Act having been amended to include them.

WHO WILL NEED AN MSIC?

Anyone who requires unmonitored access within a Maritime Security Zone will require an MSIC.

WHAT ABOUT PASSENGERS AND PEOPLE WELCOMING OR FAREWELLING PASSENGERS?

Passengers and people who are welcoming or farewelling passengers will need to comply with the Maritime Security Participants existing access control arrangements and will not require an MSIC.

For more information and updates on the MSIC Scheme, please visit the DOTARS Website www.dotars.gov.au and follow the links to the Office of Transport Security, or call the Office of Transport Security's 24-hour Operations Centre on 1300 132 400.

AQIS pest alert

>> SIAM WEED

SIAM weed is one of the world's worst weeds, with a phenomenal growth rate and massive seed production. It grows on riverbanks and in pastures, spreading through adjacent vegetation and forming impenetrable thickets up to three metres high and 10 metres across.

Siam weed's branches and triangular leaves grow in opposite pairs. From June to September it produces masses of fluffy white to pale pink flowers: its tiny seeds stick to clothing and vehicles, and Siam weed has spread to a number of countries by hitch-hiking on military equipment. For this reason all military vehicles and personal effects returning to Australia are inspected before embarkation and again on arrival in Australia.

Siam weed originated in South America, but has become a serious weed in Africa, Southeast Asia and Papua New Guinea. A limited outbreak near Tully, north Queensland, is under eradication. If Siam weed became established in Australia, control would cost millions of dollars a year and tropical crops, grazing land and natural ecosystems would be threatened.

To supplement AQIS efforts to prevent its reintroduction and for eradication to succeed, it is vital that all existing infestations are identified and reported promptly.

If you suspect you have seen Siam weed, please call the Townsville Quarantine office on 07 4789 7888.



Customers voice opinions

THE 20/20 Group carried out a survey of over fifty Port customer's attitudes and opinions.

Generally, customers believe there is a healthy day-to-day working relationship between Port customers and Townsville Port Authority employees.

Overall, 37 respondents felt the relationship with Townsville Port Authority was okay or better; 12 had some serious issues. One respondent was neutral.

Twenty customers had no complaints and 14 people felt when they had an issue they found it difficult to get a response.

Feedback on the working relationship with port control officers was very positive and customers felt that Townsville Port Authority went out of its way to help. Other departments that were well regarded included the environmental team and the finance area.

Some respondents felt the Authority could be more inclusive in terms of consultation. The various working groups were mentioned frequently, suggesting that these sub-committees are useful in encouraging two-way communication.

Whilst most customers feel their needs were being met in relation to customer focus and responsiveness to customers' needs, there were a few who thought this area could be improved.

The recently-introduced Port security charge was the most frequently-raised issue. It dominated many interviews and there is no doubt that this has influenced and coloured the overall sentiment felt by customers.

Townsville Port Authority is considered to be a key player and the Port itself is considered a very significant piece of infrastructure for the region's economy.



Townsville Port Authority has excellent working relationships with most government agencies operating in the Port, as well as a number of key organisations, including Townsville City Council, State Development and Innovation, Townsville Enterprise and Australian Airports Limited. In many cases, respondents spoke about an improvement in the working relationship compared to several years ago.

The research results flagged two areas where Townsville Port Authority had the greatest opportunity for improvement. Firstly, its communication with customers and secondly in the area of strategic planning. With the latter, the criticism was directed at specific projects, and the length of time in decision making to get projects implemented.

Customs Corner

CUSTOMS patrol vessels are now better equipped to deal with border incursions and other threats at sea following the fitting of the first deck-mounted weapons system for the Customs fleet, the Minister for Justice and Customs, Senator Chris Ellison announced in Broome last month.

For the first time, a Customs vessel, the *ACV Corio Bay*, has been fitted with a deck mounted 7.62mm general purpose machine gun.

The Federal Government has provided \$6.8 million in the 2005-06 budget and \$25.2 million over the next four years to enable Customs to fit its Bay-class patrol vessels with FN Herstal 7.62mm General Purpose Machine Guns.

Each of the 38-metre vessels in the Customs coastal patrol fleet will be progressively fitted with the weapons. The Customs and Fisheries Southern Ocean patrol vessel, the 105-metre *Oceanic Viking*, is already fitted with automatic weapons.

"These vessels form a key part of our frontline maritime defences against a range of border threats, including drugs and people smuggling, counter terrorism and foreign fishing boat interceptions," Senator Ellison said.

"Operating around our 37,000 kilometres of coastline out to, and sometimes beyond the limit of Australia's Exclusive Economic Zone, they need to be able to deal with just about any situation they encounter," he said.

Senator Ellison said that Customs patrol vessels had carried out more than 1,000 boardings at sea in the past three years.

"In order to deal with this more aggressive approach and evasive manoeuvring by intercepted ships, our Customs vessels and their crews clearly need to be both better protected and equipped to deal with these potentially hostile situations off our coastline.

"The commissioning of this weapons system indicates the Government is serious about ensuring Customs has the resources to provide this improved protection and capability," said Senator Ellison.

For further information call 1300 363 263 or visit www.customs.gov.au.

\$100,000 Donation to VP60



Chairman, Ron McLean, presents Mayor of Townsville, Tony Mooney, with the cheque.

THE Port of Townsville has contributed \$100,000 to the VP60 celebrations to be held in Townsville from 12-15 August. The contribution will be used to umbrella all events, however it will be the 'living heroes' sky show - to be held on the foreshores of the Townsville Strand, that will be absorbing the majority of the funds.

The sky show is the highlight to the program of events, which is expected to attract over 5,000 veterans and family with total attendance estimated to number 60,000.

Ron McLean, Chairman of the Townsville Port Authority, said: "During World War Two, the Port of Townsville played a pivotal role in the defence of Australia. A flotilla of ships called at the Port to facilitate the transit of war materials, equipment,

and bulk oil supplies for use by the Allied Forces. The Port was a hive of activity, handling almost 2.5 million tonnes of war material from 1942 to 1944.

"In 1942 Townsville had been described by Defence leaders as 'the last bastion', and the authorities were apprehensive that the Japanese air and naval forces would be looking for the opportunity of attacking the Port of Townsville.

"Three Japanese air raids were made on Townsville during the war with the harbour installations and ships the intended targets.

"Townsville Port was also used by "Z" Force commandos training to attack Japanese shipping in the Port of Singapore, a subsequently successful mission."

supPORTing

OUR ENVIRONMENT

Port Customers Focus on Air Quality Initiatives

NORTHERN Shipping & Stevedoring (NSS) unload zinc concentrate across Berth 3 at the Port of Townsville for transport by rail to the Sun Metals Corporation (SMC) Zinc Refinery at Stuart.

NSS & SMC have developed an Environmental Management Plan to address air quality issues such as dust generation and the management strategies required to minimise any potential impacts. As part of this plan, air quality monitoring is undertaken to ensure dust generation is minimised and ambient air quality standards are met.

Dust monitoring is conducted at Berth 3 during zinc concentrate unloading using a DustTrak™ Aerosol Monitor, Model 8520 and Environmental Enclosure mounted on a surveyor tripod (Figure 1 & 2). The DustTrak™ is fitted with a 10 m inlet allowing particles to be measured up to 10 microns in size and set at a flowrate of 1.7L/min. The equipment is set-up in close proximity to the unloading operations where dust emissions would be highest. This equipment can be considered point source monitoring as it allows dust emissions to be identified from particular sources.

Ambient air monitoring using a PM10 high volume air sampler is also carried out to monitor air quality when zinc concentrates are being



Figure 1. DustTrak™ Environmental Enclosure set-up



Figure 2. Location of the DustTrak for air quality monitoring on Berth 3 during zinc concentrate unloading.

unloaded at Berth 3. Unlike the DustTrak, high volume air sampling is influenced by a range of different sources. The high volume air sampler is positioned at Berth 9 which has an unobstructed direct line of sight to Berth 3 and samples continuously before, during and after zinc concentrate is unloaded (refer Figure 3).

By sampling the surrounding air before and after zinc concentrate unloading to determine background levels of PM10 particles and then during concentrate unloading, any differences in air quality can be determined.

The National Environmental Protection Measure for Ambient Air Quality (Air NEPM) specifies a standard for PM10 particles which is 50 µg/m³ over a 24 hour period. This standard is used to determine whether air monitoring results are acceptable. Wind speed and wind direction are also considered when analysing air monitoring results and comparisons are made with TEOM data collected at Berth 10 which is operated by the Townsville Port Authority.



Figure 3. PM10 High Volume Air Sampler at Berth 9 with Berth 3 in the background.

Under the Microscope - NSS



NSS is the largest stevedoring operation in the Port of Townsville

NORTHERN Shipping and Stevedoring was formed in 1971 and has its headquarters in Townsville. The company services the ports of Townsville, Cairns, and Mackay.

NSS Operates and manages the largest container terminal at the Port of Townsville handling the majority of the container traffic through the Port.

OPERATIONS

NSS operates berths 2 and 3 in the Port of Townsville and operates on berths 4, 8, and 9 as common user facilities. Berth 2 is dedicated to the importation of Nickel ore while Berth 3 is the longest and deepest general, bulk and container berth at the Port. It is serviced by a 55 tonne capacity portainer crane that is rail mounted together with a range of machinery including excavators, skid steer loaders and forklifts to 32 tonne.

Adjacent to Berth 3 is the NSS managed and operated container terminal consisting of 1.8 hectares of storage area with a wash down facility and power supply for reefer containers.

MAIN CUSTOMERS

The main customers for NSS include Queensland Nickel, Xstrata, Sun Metals, WMC, Incitec Pivot, Swire Shipping, Kyowa Shipping, K Line, Australian Marshalling Services and PAS.

PRODUCTS

The Queensland Nickel-owned facility at Berth 2 includes a portainer crane unloader, two shore-based hoppers, a conveyor system, a storage pad and a rail loading station. Together with a second portainer crane, NSS discharges nickel ore, operates, and maintains this total facility.

Name:	Northern Shipping & Stevedoring
Location:	Port Control Building, Level 1
Manager:	David Stringini
Employees (Townsville, Mackay, & Cairns):	50 permanent, 74 casual
Services Offered:	Stevedoring, cargo handling and storage.

In excess of 80 vessels a year are handled at the Berth 2 facility. This equates to approximately 200 days a year where there is a vessel alongside the wharf.

Lead bullion in the form of 4 tonne slabs, are received from road and rail transport on a daily basis and loaded onto the vessel by NSS.

Copper cathode bundles and zinc metal are also received by road transport on a daily basis. They are exported in two forms either break bulk or containerised depending on customer requirements.

Over 150,000 tonnes of zinc concentrate is imported through the Port of Townsville. The concentrate is sourced from domestic and overseas mines. It is discharged by NSS employees from vessels using a portainer crane and electro-hydraulic grab, dumped into a mobile shore-based hopper, and loaded to rail transport for removal to the refinery.

NSS provides a purpose built 55 tonne container crane handling and storage facility which is unmatched anywhere in Queensland outside the Port of Brisbane. Typical break-bulk cargo handled includes steel products, vehicles, logs, and earth moving equipment.

TONNAGE

NSS handles almost five million tonnes of product each financial year - both imports and exports combined.

Safety and the Environment

The NSS approach to environmental policy is designed to ensure minimal impact on the local community through its Environmental Management Plan and licence covering stockpiling, loading, or unloading goods in bulk.

NSS ensures compliance with relevant statutory requirements, ensures appropriate training for employees, ensures regular audits, and incorporates a 'best practice' approach to safety in all elements of its operations.

THE FUTURE

NSS predicts continuous improvement in its future such as maintaining a high level of service to its customers, and excellence in environmental management.

The company also plans to continue to explore opportunities to increase services and improve efficiencies while paying particular attention to safety and the environment.

Exercise Talisman Sabre a Huge Success

As our involvement in the joint Australian - US Navy exercise Talisman Sabre draws to a close, we can reflect on a very busy and challenging time.

FOR the first time in over ten years, the Port of Townsville played host to five naval vessels simultaneously and achieved a major feat of logistics with great success.

The successful operation was acknowledged by both the Association of Australian Ports and Marine Authorities (AAPMA) and the Royal Australian Navy. The efforts of all those involved in ensuring the timely and safe visits of all vessels has been much appreciated.

Australian Defence Force spokesman Lieutenant Colonel Dick Filewood was quoted as describing the exercise as "a huge success."

A formal de-briefing was held at the end of July and planning is already underway for the next Talisman Sabre exercise, which is scheduled for 2007 and is predicted to be on an even bigger scale.



USS Boxer leaves Port after taking part in Exercise Talisman Sabre

Port Embraces National Tree Day



National Tree Day on Sunday 31 July was Australia's biggest community tree-planting event.

IN partnership with the local Council, community groups and schools, National Tree Day was organised by Planet Ark and Toyota, in association with AMP Foundation. Nearly 250,000 volunteers got involved last year.

The Townsville Port Authority developed an innovative approach for this year's Tree Day. The aim was to plant enough trees and shrubs within Port grounds to offset the carbon emissions from the Authority's car fleet.

Port Authority Environmental Coordinator, Melinda Loudon, said, "Our tree day at the Port involved native plantings in the shape of the Authority's logo, to act as a living example of plant species that can thrive in our hostile conditions.

"We also unveiled an eagle pole, which has been included to encourage bird nesting away from port infrastructure. Sea Eagles and Osprey are identified as species of significant conservation value in Queensland and often nest in Port infrastructure which poses operational concerns and dangers for the nesting birds."

Port employees, family and friends participated in the Authority's contribution to Tree Day. Everyone who attended on the day received a free plant to donate to the new garden or take home to plant.

The attractive new garden will be a popular area for visitors to the Port Authority to enjoy and will eventually carry information plaques outlining the history of the Port, environmental award information and trade growth statistics.

There will also be plaques giving information on the species that have been planted.



Sophora tomentosa



Westringia wynyabbie



Melaleuca leucadendra



Scaevola (sea lettuce)

Species planted included:

- Alphitonia excelsa (Red Ash)
- Melaleuca leucadendra (Weeping Paperbark)
- Scaevola sericea (Sea Lettuce)
- Sophora tomentosa (Silver Bush)
- Lysiphylum hookeri (Native Bauhinia)
- Westringia wynyabbie (Native Rosemary)
- Talbaghia violacea (Garlic Chives)

Port Authority Chairman, Ron McLean, said, "Our activities on Tree Day have helped ensure tangible long term environmental, social and economic benefits to the Port community and the Authority. Such initiatives form an important part of our responsible and proactive approach to environmental protection. We are determined to ensure that sustainable environmental management is a core component of our operations and Port development."

Layout of the New Garden

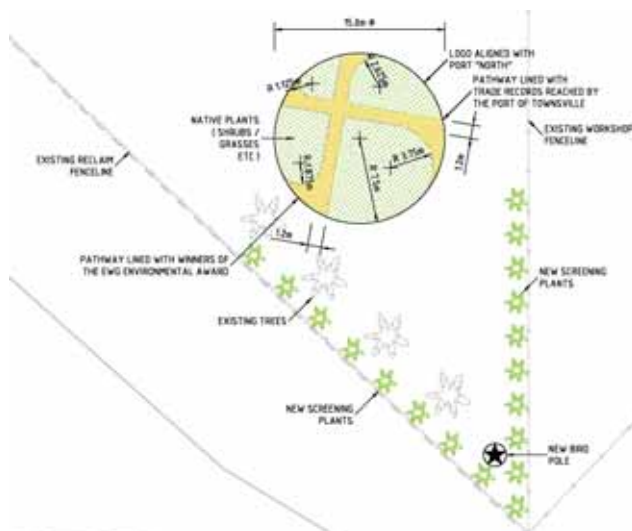

events

august

9: Port Community Forum
13: VP60 Skyshow
26: Port Authority Golf Day

september

16: Townsville Tourism Awards
18-20: Queensland Ports Association Annual Conference, Gladstone

Website Works

THE Port of Townsville website is being given a fresh new look. Work is already underway to update the site and we would love to hear your comments and suggestions on how it can be improved.

Please take the time to let us know what information you would like to see added to the site. We'd also like to know what features you use regularly and how you think they could be improved.

For those of you who aren't familiar with the site, take a look at www.townsville-port.com.au.

Please call the website team on 4781 1666 or email webmaster@townsville-port.com.au.

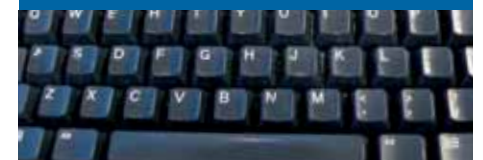

Editorial: Lesley Giblin and Clare Ryan
Photography: Stewart McLean and Lesley Giblin
Design and Layout: Verve Design, Townsville.

This newsletter is a regular, free publication of Townsville Port Authority.

An on-line version of this and other publications is available at www.townsville-port.com.au.

To submit suggestions for articles on Townsville Port and the shipping industry for future editions email publicaffairs@townsville-port.com.au.

Reproduction of information and photographs is permitted with acknowledgement.

Townsville Port Authority shall not be liable for the information or advice contained herein, and no responsibility is accepted for errors or omissions.

Townsville Port Authority hereby excludes all liability for any loss or damage suffered by any person as a result of such information or advice.

DOC TYPE: Publication
DATE: 21/07/05
TITLE: rapPORT August 2005
DOC ID: TPA 1110-050010 A
Approved: Public Affairs Officer
© Port of Townsville 2005